

# QUANTUM.

# IR5F / IR6F

# IRON

**SPECIFICATIONS :**

Hvy FW / Med Lt SW

Hvy FW / Med SW

Line Capacity

225 yds / 12 lb Line Capacity - IR5F

240 yds / 14 lb Line Capacity - IR6F

4.8:1 Gear Ratio

Weight :

15.5 oz. - IR5F

17.3 oz. - IR6F

4 Stainless Steel Ball Bearings

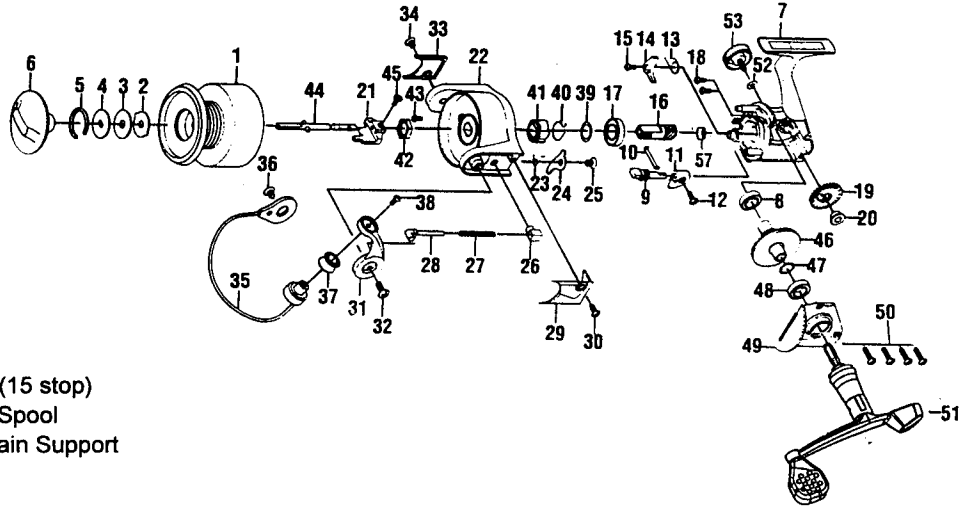

**FEATURES :**

Front Drag

Balanced Rotor

Balanced Handle

Twist Reducer Line Roller

POSI-Loc Selective Anti-Reverse (15 stop)

Aluminum Long Stroke Max-Cast Spool

Aluminum Side Cover for Drive Train Support

Brass Pinion and Drive Gear

Key No.	Part No.	DESCRIPTION	Price	Key No.	Part No.	DESCRIPTION	Price
1	BH321-36	BH321-45 Spool Assembly	11.54	26	BH020-11	Spring Holder	0.96
2	BH081-21	Spool Washer "A"	0.59	27	BH022-31	BH022-41 Arm Lever Spring	0.64
3	BH033-21	Spool Washer "B"	0.64	28	BH031-31	Spring Shaft	0.96
4	BH080-31	Spool Washer "D"	0.96	29	BH046-36	BH046-45 Arm Lever Cover	1.85
5	BH038-21	Drag Retainer	1.01	30	BH085-14	Cover Screw	0.62
6	BH332-35	BH332-45 Drag Knob Assembly	3.35	31	BH007-13	Arm Lever	2.44
7	BH001-36	BH001-45 Body (before A8 date code)	6.70	32	BH044-14	Arm Lever Screw	0.62
7	BH001-48	Body (after A8 date code)	6.70	33	BH024-34	Bail Holder Cover	1.80
8	BH027-12	Ball Bearing	6.58	34	BH085-14	Cover Screw	0.62
9	BH090-11	Stopper Cam	1.60	35	BH347-33	BH347-43 Bail Assembly	5.20
10	BH089-11	Stopper Cam Spring	0.96	36	BH044-14	Bail Holder Screw	0.62
11	BH059-14	Stopper Lever	1.08	37	BH004-14	Line Roller Ball Bearing	4.14
12	BH135-13	Stopper Lever Screw	0.47	38	BH108-14	Bail Screw	0.62
13	BH061-11	Stopper Spring	0.46	39	BH110-31	Bearing Washer	0.54
14	BH063-32	Stopper	1.53	40	BH086-31	Silent Spring	1.65
15	BH077-11	Stopper Screw	0.64	41	BH060-32	Ratchet Gear	1.80
16	BH011-31	Pinion Gear (before A8 date code)	3.34	42	BH006-31	Rotor Nut	1.22
16	BH011-32	Pinion Gear (after A8 date code)	3.34	43	BH094-11	Rotor Nut Lock Screw	0.64
17	BH028-31	Ball Bearing (before A8 date code)	7.43	44	BH315-31	BH315-41 Main Shaft Assembly	5.84
17	BH028-32	Ball Bearing (after A8 date code)	7.43	45	BH100-11	Main Shaft Screw	0.64
18	BH041-11	Bearing Screw	0.64	46	BH012-32	Driver Gear	3.14
19	BH053-31	O/S Gear	2.71	47	BH026-11	Adjust Washer	0.69
20	BH158-11	O/S Gear Bushing	0.98	48	BH027-12	Ball Bearing	6.58
21	BH025-31	O/S Slider	2.71	49	BH023-36	BH023-45 Body Cover	2.68
22	BH009-36	BH009-45 Rotor	6.70	50	BH057-14	Body Cover Screw	0.62
23	BH049-31	BH049-41 Kick Lever Spring	0.96	51	BH318-36	Handle Assembly	7.21
24	BH019-31	BH019-41 Kick Lever	1.97	52	BH105-11	Handle Cap Washer	0.47
25	BH136-11	Kick Lever Screw	0.64	53	BH073-33	Handle Screw Cap	2.44

☐ = These parts are not interchangeable with parts from different date code (ie., use Pinion Gear before A8 along with Ball Bearing and Body before A8)

<b>MODEL</b>	<b>EFFECTIVE DATE OF</b>	
<b>INTRODUCED : 1997</b>	<b>PARTS LIST/DIAGRAM : Sept. '98</b>	<b>DISCONTINUED : N/A</b>

Prices subject to change without notice. Prices do not include postage and handling.

PLEASE ORDER BY PART NUMBER

Zebco, P.O. Box 270, Tulsa, Ok. 74101; 918-831-6965 Phone or 800-FIXREEL (349-7335) FAX

